



EN50131-2-6 GR2 CL IV

- Complies with EN50131-2-6
- Floor mounting
- Die-cast aluminium housing
- Long operation distance
- With anti-tampering wire loop
- Steel sheath

Series 450 N

Housing material	Die-cast aluminium
Operation	Reed contact with NC output with near magnet
Type of connection	Wires (2 for contact + 2 for anti-tampering)
Operating temperature	-25°C to +60°C
Protection rating	IP 65
Standard equipment	Anti-tampering caps, 10 mm diameter protective cable sheath, length 1.2 m, in steel with black PVC coating, anti-tampering wires

Dimensions

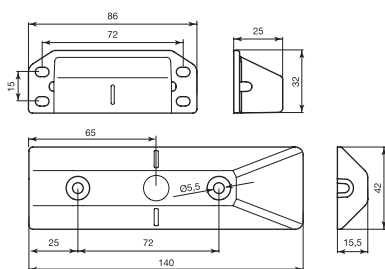
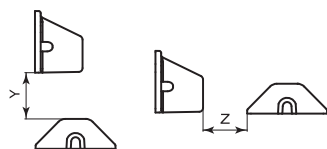

Diagram of Y and Z distances



Order codes

Code	Y max/Z max (no iron)	Y max/Z max (on iron)	Connection type	Max voltage	Max current	Max power	Cable N° wires/length	Safety grade	Environmental class	Package weight
450-N	40/28 mm	32/25 mm	NC*	42.4 Vpeak - 60 V DC	1 A	10 W	4 / 1.2 m	2	IV	0.34 Kg

"Safety grade" and "Environmental Class" as per European Standard EN 50131-1

Y max: maximum vertical installation distance; Z max: maximum horizontal installation distance (see diagram below).

For other operating distances, see the instructions sheet at www.coopercsa.it

* With near magnet

Accessories

AG-10	Black PVC-coated steel sheath - 10 m
-------	--------------------------------------

Series 450 N

Magnetic contact for garage doors

Aluminium magnetic contact for garage or sliding/folding doors. It is a new version of contact series 450 with the following enhancements: new look, longer operating distances, reed part mounting with only two screws that can be protected by special metal caps, possibility of cable entrance from the ground, magnet part with smaller vertical hole distance for simpler mounting on the door

The strong housing construction of die-cast aluminium ensures maximum resistance to the wheels of heavy vehicles, fork-lift trucks etc., making it suitable for heavy-duty applications.

The long operating distances also work perfectly where there is a large gap between doors.

The reed section contains a tightly sealed reed with polyurethane resin and anti-tampering loop to reduce any risk of intrusion. Connection uses 4 wires (2 wires for NC contact with near magnet and 2 wires for anti-tampering), protected by a steel sheath, and covered by black PVC.